

Ranchland Acres Water Main Replacement Project

Non-Mandatory WebEx Pre-Bid Meeting

Tuesday, September 7, 2021

Adam Eddy, P.E.

Project Engineer, Production Engineering

Janie M. Powell

Contract Administrator

Marisol V. Robles

SMWVB Program Manager

John Mooneyham, P.E.

Engineer of Record, Civil Engineering Consultants, Inc.

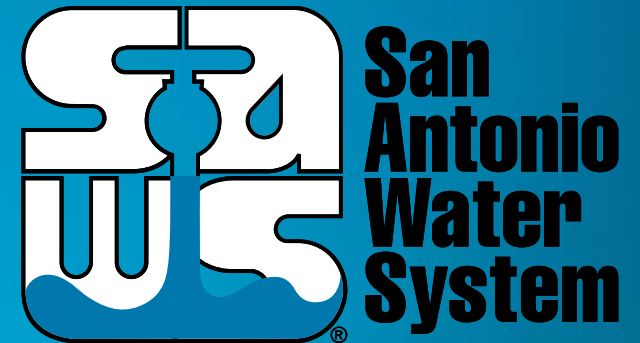

MAKING SAN ANTONIO
WATERFUL



WebEx Housekeeping

- Stay muted during the entire presentation.
- Sign-In using the Chat feature ensuring to select “Everyone” from the drop down menu with name, company name and contact information.
- Ask questions at any time during the presentation utilizing the Chat. Questions will be addressed at the end of the presentation.
 - Ensure to direct your questions to the entire group by selecting everyone from the drop down.
 - All formal responses to questions will be provided via an Addendum.
- Audio only attendees may follow along on the presentation posted to the SAWS solicitation website.

Oral Statements

Oral statements or discussion during the pre-bid meeting today will not be binding, nor will it change or affect the terms or conditions within the Plans and Specifications of this Project. Changes, if any, will be addressed in writing only via an Addendum.

Agenda

- General Information
- Small, Minority, and Woman-Owned Business (SMWB Requirements)
- IFB Schedule
- Contract Solicitation Website
- Vendor Registration & Notification (VRN)
- Contract Requirements
- Project Overview
- Bid Packet Preparation
- Key Reminders
- Temporary Bid Opening Instructions
- Contact Information
- Technical Information

General Information

- Non-mandatory pre-bid meeting
- Presentation has been posted on SAWS website
- Geotechnical Report available on the SAWS website upon signing the disclaimer form
- Construction services being procured through IFB
- Construction Estimate: \$1,612,091.00
- Calendar Days: 240 days

Aspirational SMWB Goal

Industry	Aspirational SMWB Goal
Construction	20%

The aspirational SMWB goal is 20% of the total bid price.

Accepted SMWVB Certification Agency

Minimum Qualifications for SMWVB recognition:

- South Central Texas Regional Certification Agency
 - MBE, WBE, SBE (Includes “HUB” Program)
- SBE-Certified (even MBEs and WBEs)
- Local office or local equipment yard

Good Faith Effort Plan (GFEP) FAQs

- **Q: Is the 20% aspirational SMWB goal mandatory?**
A: No, but we ask prime contractors to do their best with good faith outreach efforts. If the goal is not met, proof of outreach efforts is required with the submittal.
- **Q: What if I am having trouble finding SMWB subcontractors?**
A: Please email the SMWVB Program Manager with the scopes of work you are seeking. You will receive lists of local SMWVB-certified firms to contact within 1-3 days.
- **Q: What if my business is SMWB-certified? Do I need to find SMWB subs?**
A: The GFEP is a required document, and a good faith outreach effort is still necessary.
- **Q: Do I need to include all my subcontractors in the GFEP or just those that qualify towards the SMWB goal?**
A: All subcontractors need to be included in the GFEP, even those that do not count towards the SMWB goal.
- **Q: What if I have questions about the GFEP?**
A: Please contact the SMWVB Program Manager at 210-233-3420, or at Marisol.Robles@saws.org. GFEP questions can be asked at any time before the submittal is due.

Post Award: Subcontractor Payment & Utilization Reporting (S.P.U.R.) System

1. Subcontractor & Supplier Payment Tracking
2. Subcontractor and Supplier Additions or Substitutions
3. LCP Tracker
4. Must be Current and Accurate before Retainage is released

<https://saws.smwbe.com>



Ranchland Acres Water Main Replacement Project



IFB Schedule

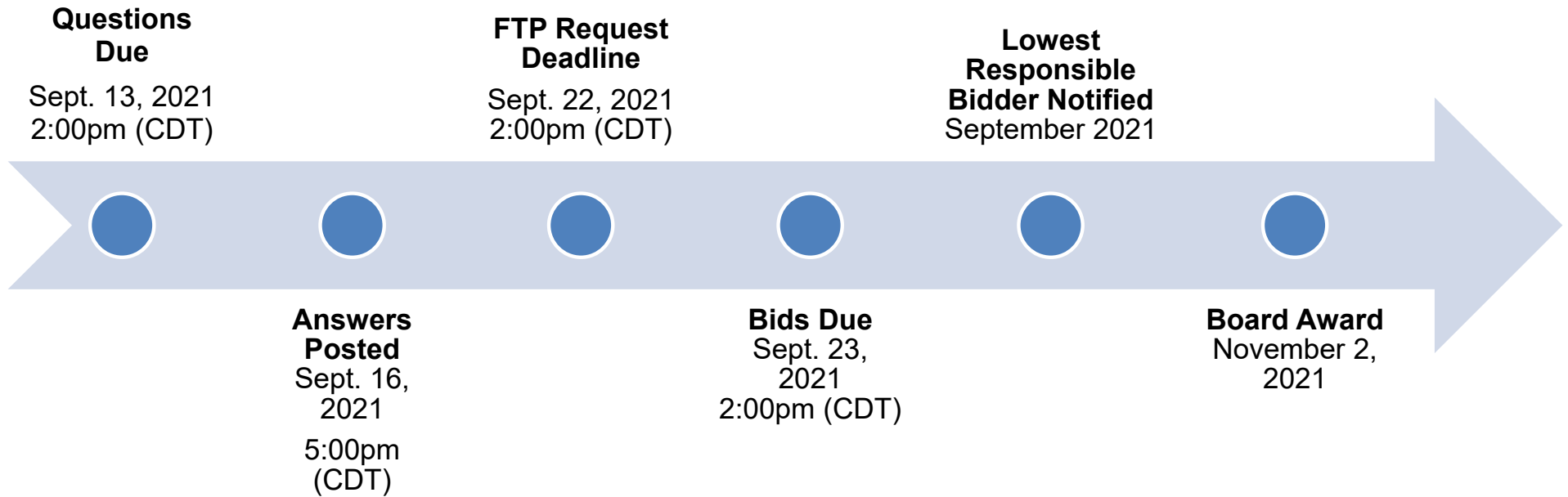

Contract Solicitations Website

- To locate the Contract Solicitations website choose Resources

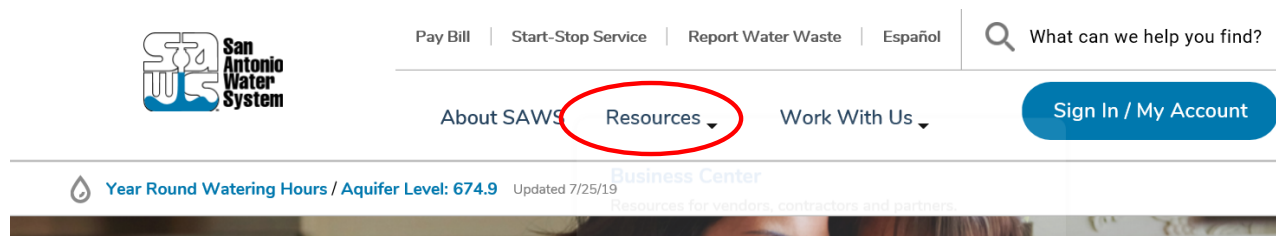

- At the drop down menu choose Contract Solicitations.

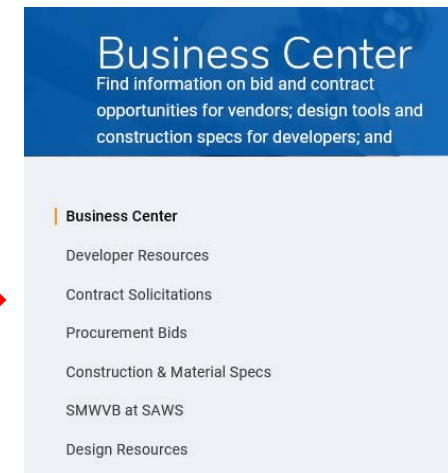

Vendor Registration & Notification (VRN)

Reasons to Register in the VRN

- Receive bid notices directly in your email “Inbox”.
- Download bid documents.
- Subscribe to specific bids.
- Receive addendum notifications.



Notify Me

Receive updates sent straight to your inbox.

Subscribe

https://apps.saws.org/Business_Center/Contractsol/

Contract Requirements

Prevailing Wage Rate and Labor Standards – Section 2.10 of the General Conditions

- Payroll records are subject to review
- Contractors to utilize LCP Tracker
- Certified payroll to be submitted on weekly basis
- Contractors are responsible for sub-contractor payroll
- Late payrolls delay contractor payments from SAWS
- Wage decisions are included within the specifications
- Site visits are random and unannounced
- Interviews will be conducted and will be private & confidential
- All apprenticeship programs will need to be approved by Department of Labor prior to starting

Contract Requirements

Supplemental Conditions

- Insurance requirements are found in Section 5.7 of the GCs
 - Installation Floater in lieu of Builder's Risk
 - Maintain insurance coverage during the construction of this Project
- Will ask for insurance prior to Board award to expedite execution of the contract
- Compliant prior to executing the contract

Contract Requirements

Supplemental Conditions (Continued)

Apparent Low Bidder

- Notified within 24 hours of Bid Opening
 - To provide the following within one (1) business day
 - Conflict of Interest Questionnaire - Form CIQ (Rev. 1/1/2021)
 - Proof of Insurability
 - Company Information Packet
 - Statement regarding ability to complete the project
 - W-9
- *And, if bid was submitted electronically without a Bid Bond:
- Cashier's Check or Certified Check

Contract Requirements

Apparent Low Bidder (Continued)

- To provide the following within one (1) business day
 - Statement of Bidder's Experience Form
 - Record of performance on three (3) similar projects
 - Includes the installation of 8-inch to 16-inch diameter HDPE pipe combined total length of at least 3,500 L.F.
 - Projects must have included the installation or relay of at least 50 water service lines.
 - Projects must have included relocation of water mains and services within residential areas.
 - Projects must have been completed within the last 5 years
 - Detailed Baseline Schedule
 - Estimated notice to proceed date of December 1, 2021

Contract Requirements

Supplemental Conditions (Continued)

- Contractor shall perform the work with its own organization on at least 40% of the total original contract price which should be indicated on the Good Faith Effort Plan.

Prime Contractor's Percentage of Participation: (Ex: 100% is the total value of the contract.) _____ %

- Liquidated damages will be assessed at \$400.00 per day

Bid Packet Preparation

- Utilize the Bid Packet Checklist within the specifications
- Double check all mathematical calculations and verify all extensions
- Ensure Mobilization and Preparing Right-Of-Way do not exceed percentage
- Addendums are acknowledged on the Bid Proposals
 - Check our website regularly for addendum postings
 - It is possible to have multiple addendums during the time frame in addition to the scheduled final addendum

Key Reminders

- All questions should be sent in writing to the corresponding Contract Administrator by email or fax.
- Please identify the project by its associated solicitation number.
(CO-00437)

Temporary Bid Opening Procedures

- Bids will be submitted using SAWS' temporary bid opening procedures
- SAWS encourages and prefers the submission of electronic bids using its secure FTP site.
 - Bidders should submit a request via email to obtain access to the site no later than 24 hours before the bid opening.
- Or, Bidders may drop off bid; but only the required items
 - Drop box is located at 2800 US Hwy 281 N, Customer Service Tower
 - Enter the first set of glass double doors
 - Insert into the black drop box on the wall on the left hand side
- Late bids will not be accepted and will be returned unopened.
- Bid Opening will be handled via WebEx only; link found in IFB

Contact Information

<u>Contact Name</u>	<u>Title</u>	<u>Telephone Number</u>	<u>Email address</u>
Janie Powell	Contract Administrator	210-233-2443	Janie.Powell@saws.org
Marisol Robles	SMWVB Program Manager	210-233-3420	Marisol.Robles@saws.org

REMINDER

Please be advised that Bidders are prohibited from communicating with any other SAWS staff, the Consultant, the Developer, or City of San Antonio officials regarding this IFB up until the contract is awarded as outlined in the Instructions to Bidders

Project Overview

Work Location No.1 Ranchland Acres

Work Location No.2 McNeel & Montpelier

Work Location No.3 Shadwell & St. Cloud

Work Location No.4 Zachry & Donaldson

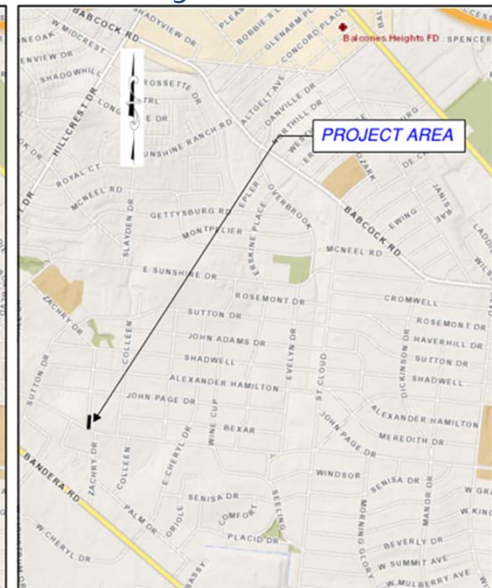
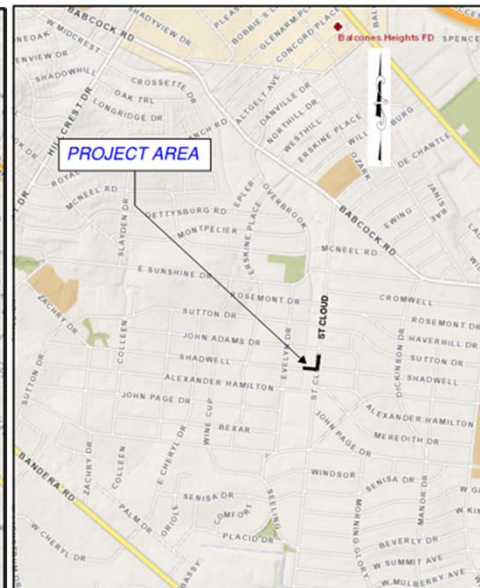
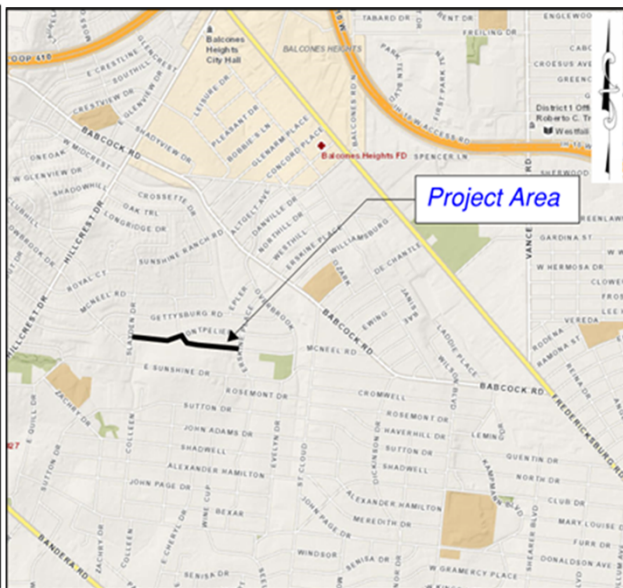
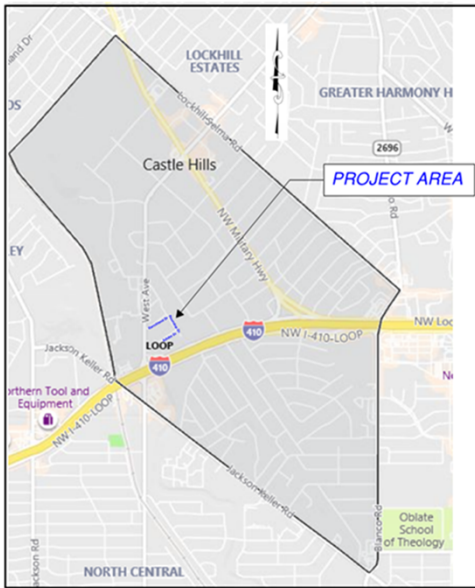

Ranchland Acres Water Main Replacement Project



Project Overview

WORK LOCATION NO. 1

Ranchland Dr.

(Replace mains – 8" & services)

- City of Castle Hills
- Old BexarMet Facilities (DSP)
- Streets
 - West Ave.
 - Ranchland Dr.
 - Roundup Dr.
 - Adobe Dr.
- Objective
 - Replace approx. 2,200 L.F. of existing 6" D.I. water main and services with new 8" HDPE
 - Mill & Overlay Streets

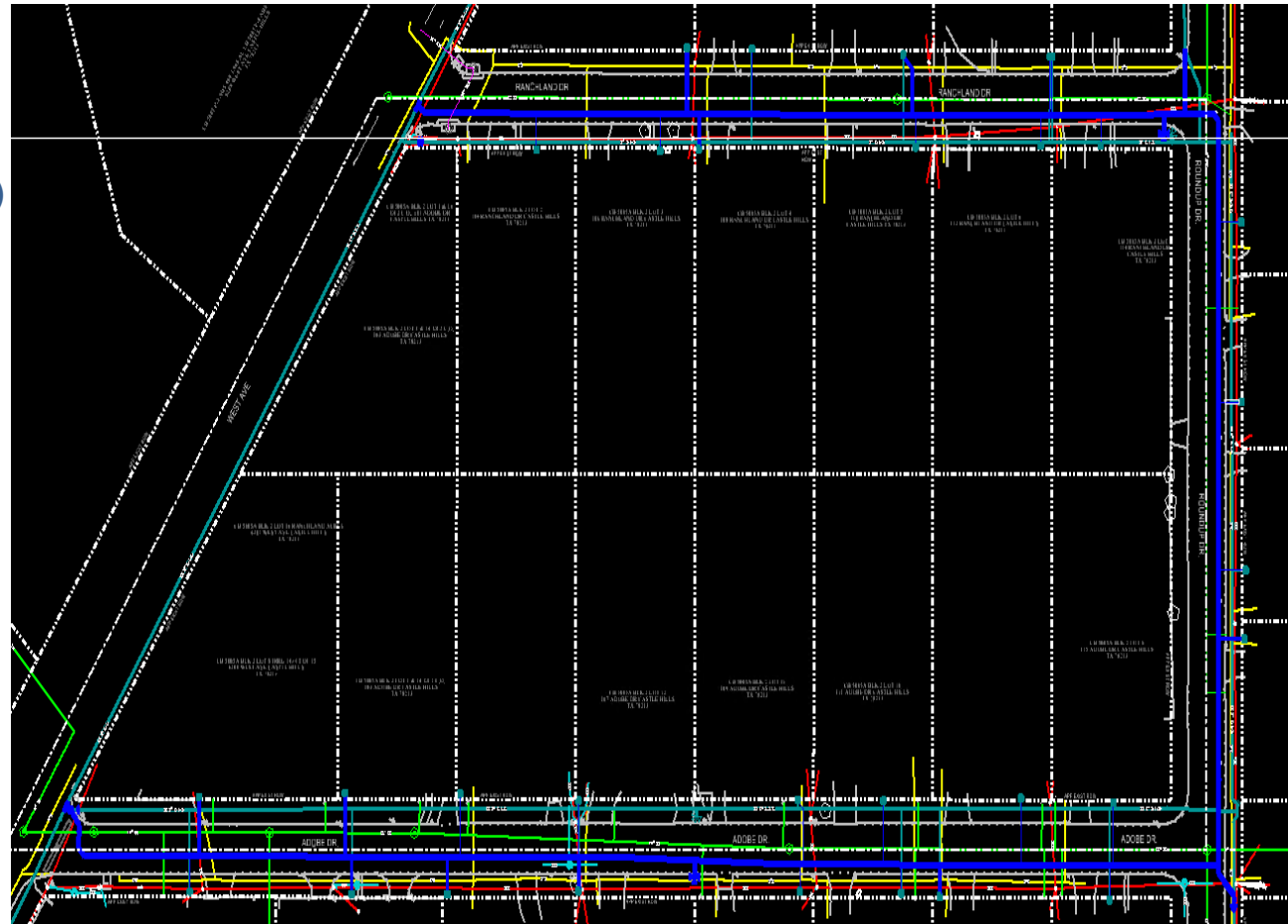

Ranchland Acres Water Main Replacement Project

Project Overview

WORK LOCATION NO. 2 McNeel & Montpelier (Replace mains – 16" & Services)

- City of San Antonio
- Streets
 - McNeel (Erskine to Montpelier)
 - Montpelier (Slayden Dr. to McNeel)
- Objective
 - Replace approx. 2,300 L.F. of existing 16" D.I. water main and services with new 16" HDPE
 - Standard Trench Pavement Repairs

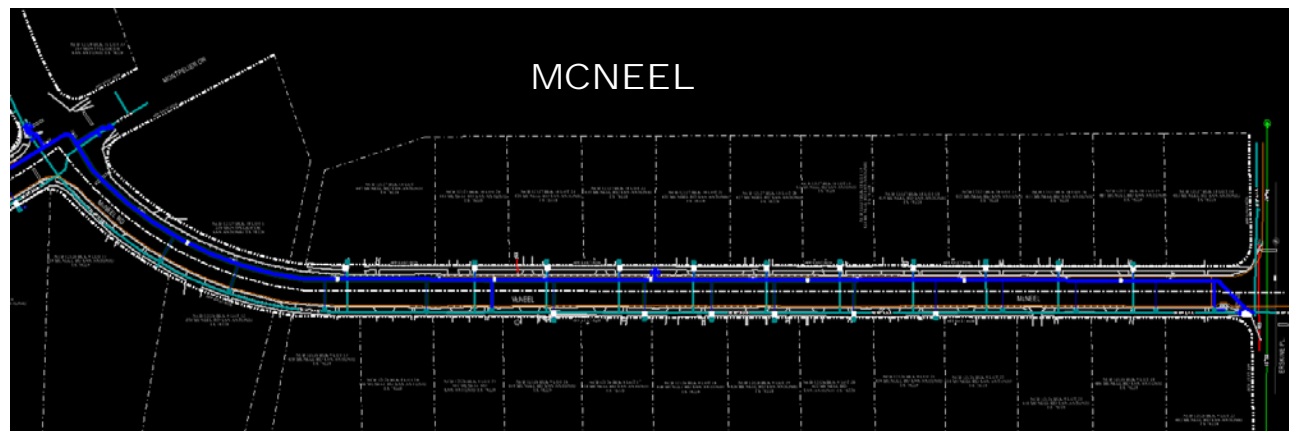
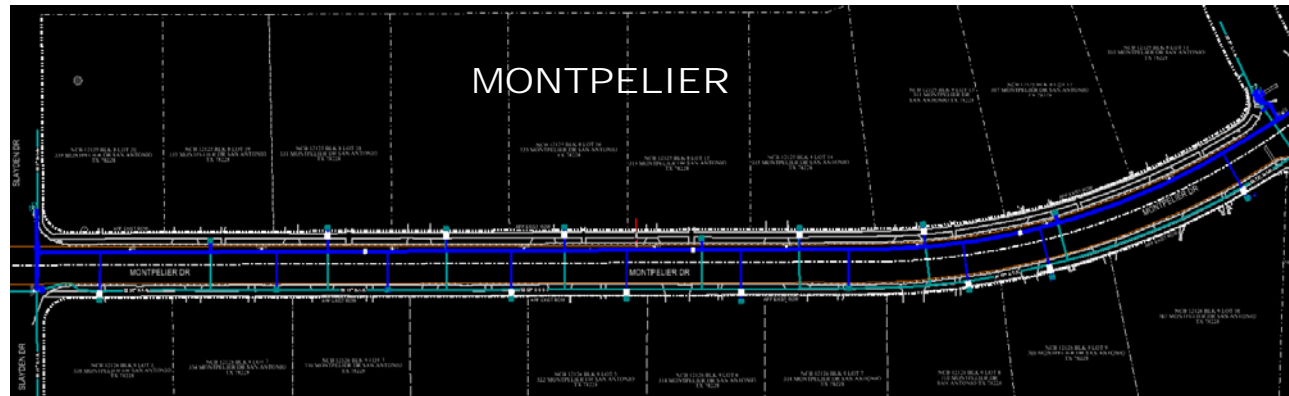

Project Overview

WORK LOCATION NO. 3 St. Cloud / Shadwell (Dead End Main – 8”)

- City of San Antonio
- Streets
 - St. Cloud
 - Shadwell
- Objective
 - Eliminate Existing Dead-End Main (8” PVC) on Shadwell by extending and connecting to an existing 12” A.C. water main on St. Cloud
 - Standard Trench Pavement Repairs
 - Cross beneath CPS Energy 16-SP Main

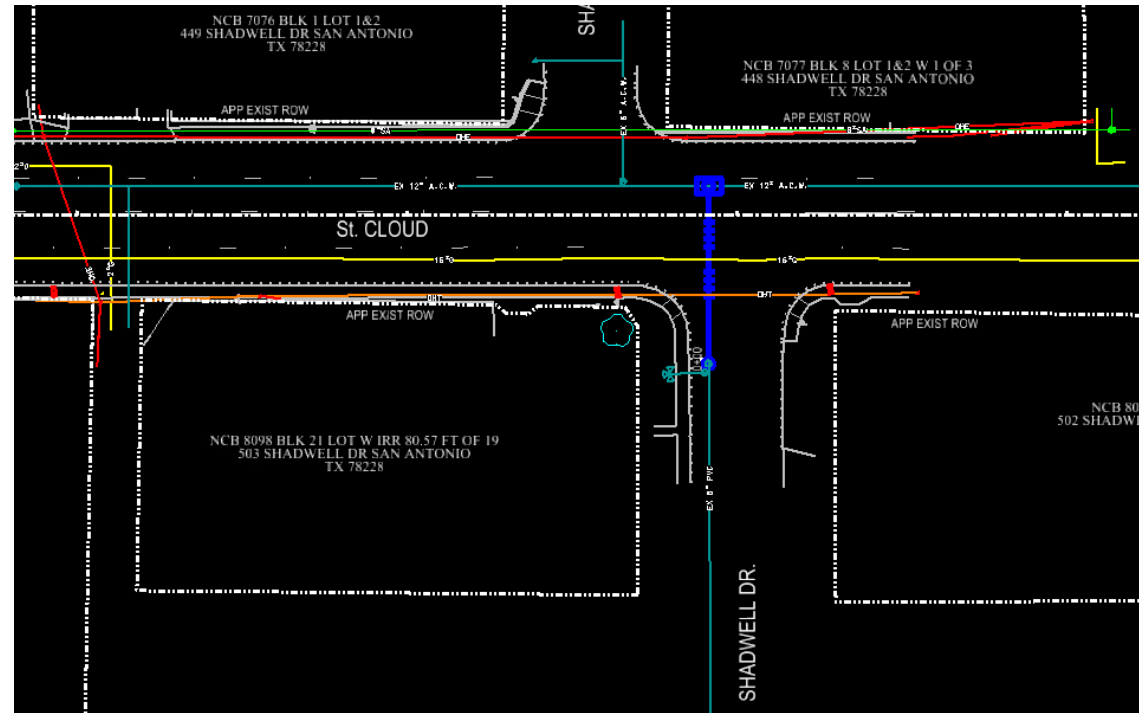

Project Overview

WORK LOCATION NO. 4 Zachry Dr./ Donaldson Ave. (Dead End Main – 8")

- City of San Antonio
- Streets
 - Zachry
 - Donaldson Ave.
- Objective
 - Eliminate Existing Dead-End Main (8" PVC) on Zachry by extending and connecting to an existing 12-inch D.I. water main on Donaldson Ave.
 - Standard trench repairs on Zachry
 - Mill & Overlay Donaldson Intersection

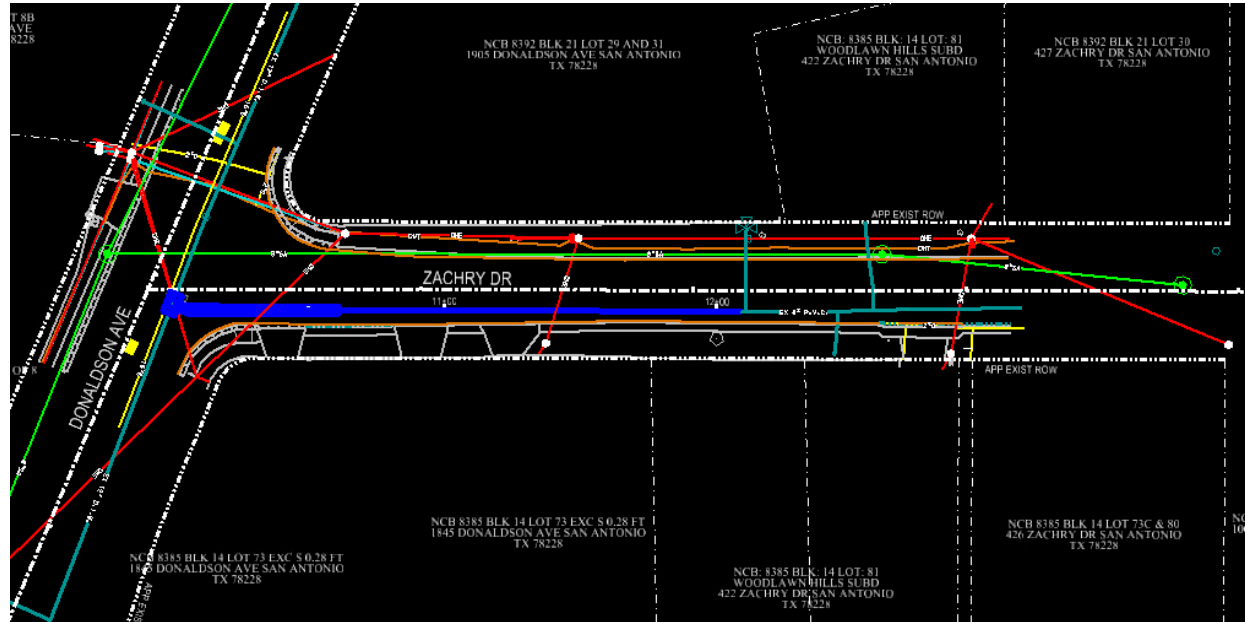

QUESTIONS



Reminder: Oral statements or discussion during the pre-bid meeting today will not be binding, nor will it change or affect the terms or conditions within the Plans and Specifications of this Project. Changes, if any, will be addressed in writing only via an Addendum.